



Preparing for disasters: Typhoon and Cyclones

A road to resilience in Southeast Asia



Inside a small wooden hut, at the foot of Mud Mountain...



...Ton is peacefully dreaming, when suddenly an alarm wakes him



Ton, you must leave now! A cyclone is coming!! Can you hear the alarm?

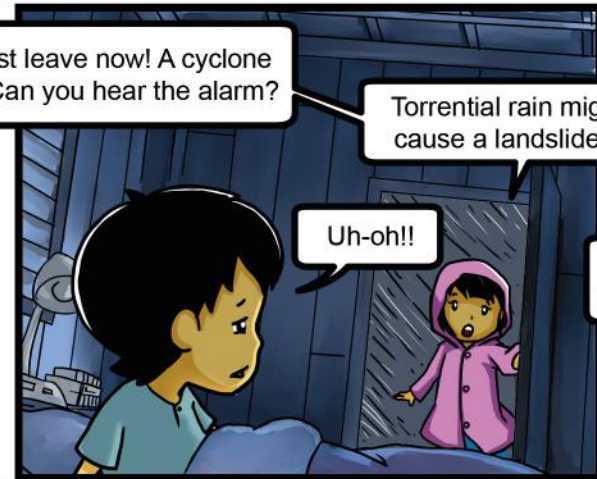

Torrential rain might cause a landslide!!!

Uh-oh!!



And strong winds could destroy this hut!

You should leave now before the cyclone comes!



Pack emergency supplies in a bag, like water and food



If you have waterproof clothes, wear them!

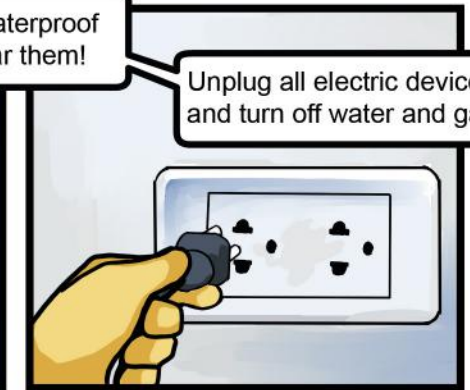

Unplug all electric devices and turn off water and gas.



Come straight to my house Ton, it will be safer there

Thanks Fah.



Stay alert Ton. Listen for unusual sounds.

Like trees cracking?

Yes, or rocks knocking each other.



Let's get away from here right away.

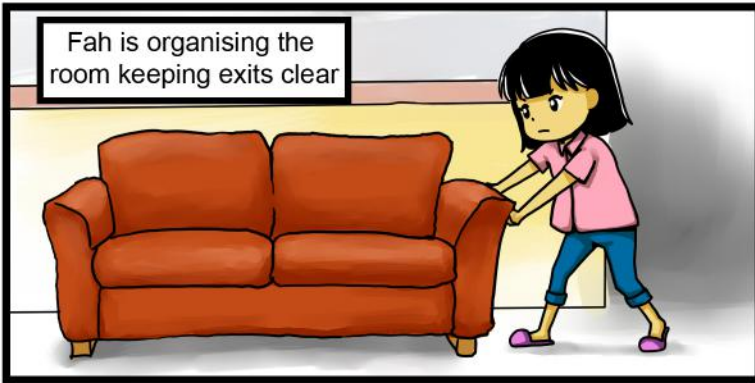

Below is a list of things to remember if there is a typhoon. Study it well, these tips could make all the difference for you and your family!

- Make sure everyone in your household knows where and how to evacuate to
- Take part in risk mapping and cyclone preparedness planning where you live
- Keep important documents and valuables in a waterproof bag, and store above potential flood water
- Inspect your roof at the beginning of the cyclone season and make repairs. For lightweight roofs, secure sandbags on top
- If you think you are in danger, evacuate immediately away from the cyclone's direction of movement
- Turn off electricity, gas supply and water and disconnect any electrical appliances
- Check that your evacuation supplies and your 'go bags' are ready, including water and food.
- Charge mobile phone batteries
- You need to evacuate if you live on the coast, on a flood plain, near a river, or in a temporary or lightweight structure
- Do not evacuate during the cyclone



To learn more about disasters, please visit:
www.redcross.org/prepare/disaster/hurricane

International Federation of Red Cross and Red Crescent Societies

Southeast Asia Regional Delegation

Community Safety and Resilience Unit
Ocean Tower I, 170/11-12 Sukhumvit soi 16, Klong-toey
10110 Bangkok, Thailand
T: +662 661 8201 F: +662 661 9322
E: thailand.regionaloffice@ifrc.org

www.ifrc.org
Saving lives, changing minds.

Made possible with the support of



Humanitarian Aid
and Civil Protection

